



**THE OHIO STATE UNIVERSITY**

OUTPATIENT PHARMACY

## A Full-Service Pharmacy With Specialty Expertise

*A state-of-the-art pharmacy that provides personalized service by staff who are dedicated to improving patient care by easing the challenges of managing medications*

*Please let us know how we can assist you with your medication needs.*

---

### The Ohio State University Outpatient Pharmacy

**Location:** Conference Level of the  
James Cancer Hospital and  
Solove Research Institute  
460 W. 10<sup>th</sup> Ave., L012  
Columbus, Ohio 43210

**Telephone:** 614-293-5920

**Fax:** 614-366-0097

**Additional information:** [go.osu.edu/retailpharmacy](http://go.osu.edu/retailpharmacy)

#### Hours of Operation:

Monday-Friday  
8 a.m.-9 p.m.

Saturday-Sunday  
9 a.m.-6 p.m.

---

#### Benefits:

- A resource to fill all of your medications, including specialty medications
- Faster access to your prescription medications due to our insurance expertise
- Medication assistance programs to help lower the cost of therapy
- Education about your medication by highly trained pharmacists
- Specialty medication Patient Management Program
- Free delivery of medications to a James or WMC clinic during a patient's visit

Visit us online at [go.osu.edu/retailpharmacy](http://go.osu.edu/retailpharmacy)

# Walk-in Location Directions

to the Outpatient Pharmacy

## GROUND FLOOR MAP OF THE JAMES

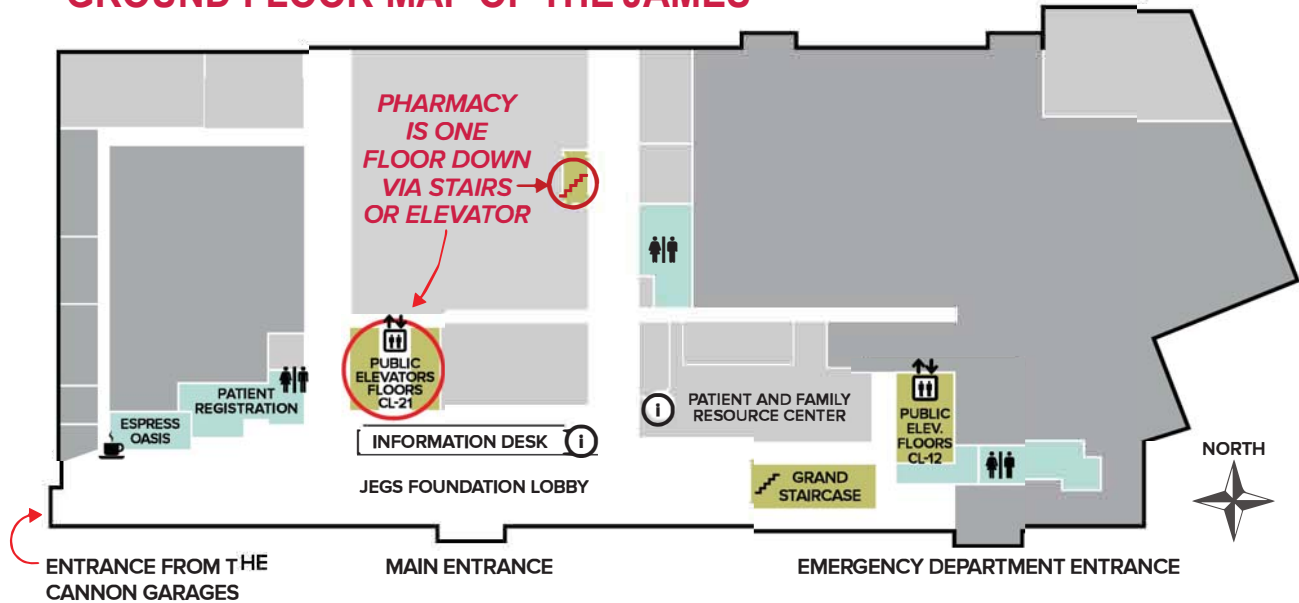

## CONFERENCE LEVEL MAP OF THE JAMES

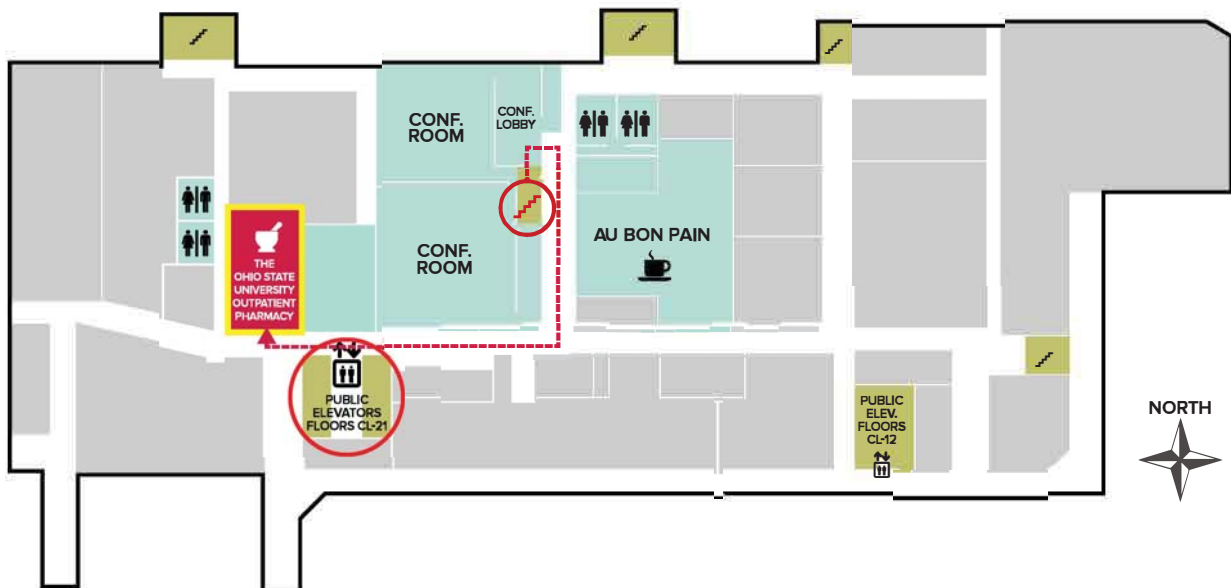

Elevators



Information



Stairs



Food & Beverage

Learn more:

[go.osu.edu/retailpharmacy](https://go.osu.edu/retailpharmacy)